

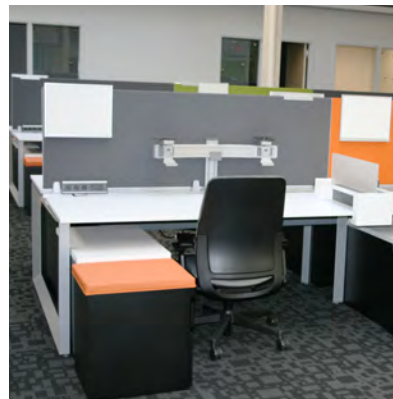

For more than 100 years, we've created smarter workplaces that solve customers' business issues. We bring together the best strategies, products and services that help people work more effectively, today and tomorrow.



As 2Checkout, a **leading global payment solutions provider**, prepared to add to its complement of 100 employees at its new headquarters, they **called on LOTH to create a brand-related workspace to accommodate their growing company.**

Challenge:

- **real estate footprint:** use the available space to the best advantage and plan for future growth
- **talent:** attract and retain the right employees
- **branding:** use the space to reflect the global brand
- **company culture:** create a space that provides for multiple generations in the workplace
- **ensure employee satisfaction:** assess each department's workspace needs

Strategy:

- **uncover workplace trends:** blend an open, call center-type atmosphere with private offices
- **determine collaboration needs:** how groups interact with other departments and what constitutes team collaboration
- **functionality:** provide each team member with an appropriate and functional workspace
- **think creatively:** graphics representing 2CO's global footprint

LOTH
provides a
comprehensive
solution
for
2CO

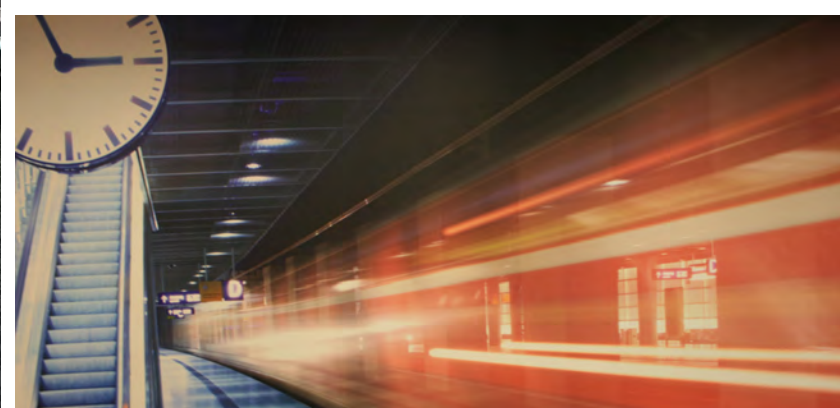
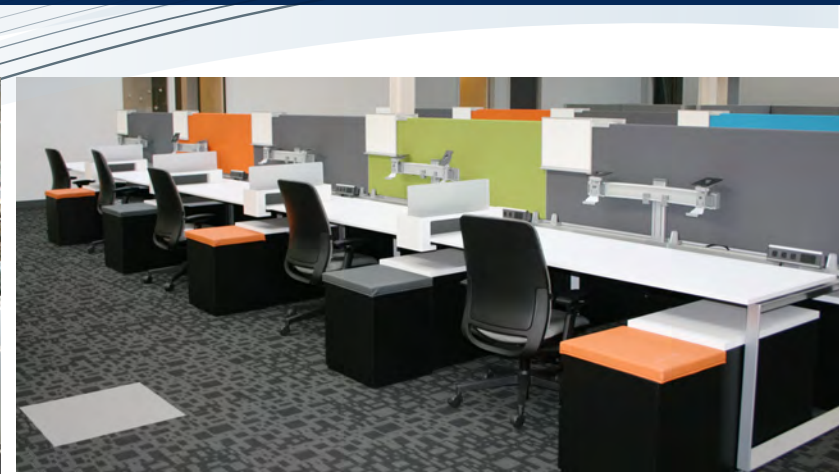

Solution:

- **user-friendly:** workstations with appropriate worktools
- **maintain an open space:** avoided using solid walls that block the light
- **full service:** used LOTH's furniture and flooring divisions to ensure smooth project management

Result:

- **new space, new look:** a clean, modern look with pops of saturated color
- **collaborative interaction:** environment supports collaborative interaction within an open-plan setting
- **culture:** accommodates multiple generations and improves morale due to improved aesthetics
- **multiple settings:** provided a variety of open and enclosed areas, for work and impromptu meetings

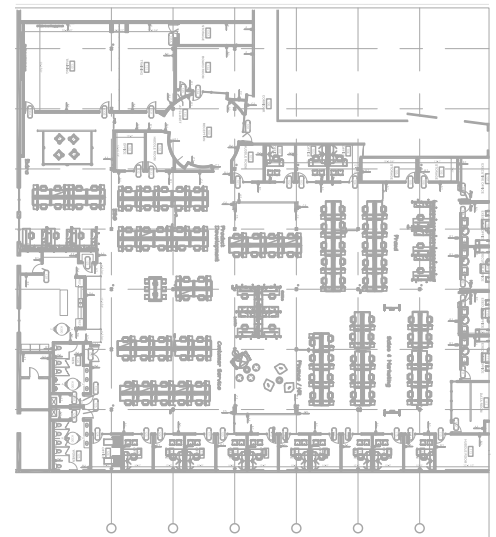

www.lothinc.com

3574 E. Kemper Road
Cincinnati, Ohio 45241
513.554.4900

855 Grandview Avenue
Columbus, Ohio 43215
614.487.4000

