



For more than 100 years, we've created smarter workplaces that solve customers' business issues. We bring together the best strategies, products and services that help people work more effectively, today and tomorrow.



A partial renovation at the University of Cincinnati's College of Engineering & Applied Science resulted in updated engineering labs and a new Alumni Engineering & Applied Sciences Learning Center for undergraduates. UC was impressed by Steelcase's research and insights and chose LOTH to create a much more engaging environment where people are actively involved in the process of learning.

Challenge:

- impact: enhance freshman integration into the engineering community on campus
- understand and accommodate: enhance the way engineering students learn through technology and collaboration
- product mix: non-traditional classroom styles
- collaboration: support small-group and hands-on activities
- overall space: reflect a new direction for delivering the educational experience - different, creative, open, fun

Solution:

- multipurpose and divisible spaces: accommodate scheduled class needs associated with laboratories as well as breakout space for student projects
- collaboration needs: analyze how groups interact
- zones: provide open and private settings; appropriate spaces that support collaboration and classroom activity

LOTH
creates
innovative,
active-
learning
environments

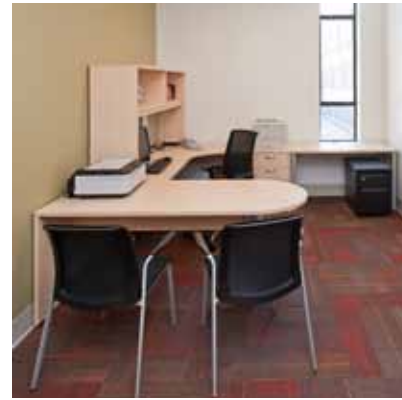

Result:

- product selection: casual, appropriately shaped tables and flexible, mobile seating
- future-focused: provides a state-of-the-art template for smart, active-learning spaces
- integrated technology: whiteboards that interact with laptops enhance collaboration and productivity
- outcome-based design: the Center is an attractive, dynamic destination that encourages student use
- student reaction: students dubbed the casual, collaborative lounge "The Origin" and love the paper tables they can write on

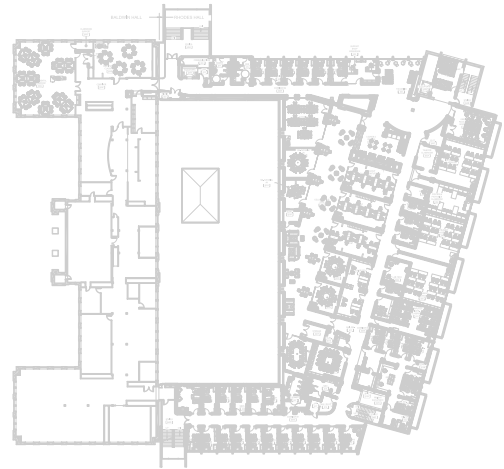

"LOTH did an amazing job. ...I was especially appreciative of such a dedicated LOTH team. The job looks really beautiful.

I have full confidence that when the vending, multipurpose and experimental classrooms are complete, that LOTH will set them up and check thoroughly.

Tracy Herzer
IIDA, Associate



www.lothinc.com

3574 E. Kemper Road
Cincinnati, Ohio 45241
513.554.4900

855 Grandview Avenue
Columbus, Ohio 43215
614.487.4000

