



For more than 100 years, we've created smarter workplaces that solve customers' business issues. We bring together the best strategies, products and services that help people work more effectively, today and tomorrow.



With a **future-focused intent**, Cincinnati State Technical and Community College made a **significant commitment** to establishing a campus in Middletown's downtown core, **an ambitious expansion from the main campus**. Working with partners, CSTCC was able to renovate and set up shop in the former Cincinnati Gas & Electric Building. The facility includes classrooms and labs, student services areas (enrollment, advising, counseling, financial aid, study areas) and offices.

The community college's vision: create a campus atmosphere in downtown Middletown.

Challenge:

- **impact:** enhance student integration into the campus community
- **understand and accommodate:** create a space that will attract and retain students and faculty
- **product mix:** provide budget-friendly, green solutions
- **collaboration:** support small-group and hands-on activities
- **issues:** capacity for initial enrollment as well as future needs
- **brand building:** use space as a brand tool

LOTH
creates
innovative,
active
learning
environments



Solution:

- **multi-purpose spaces:** accommodate scheduled class needs as well as breakout space
- **collaboration needs:** both inside and outside the classroom – every space is a learning space
- **zones:** provide open and private settings, appropriate spaces that support collaboration and classroom activity

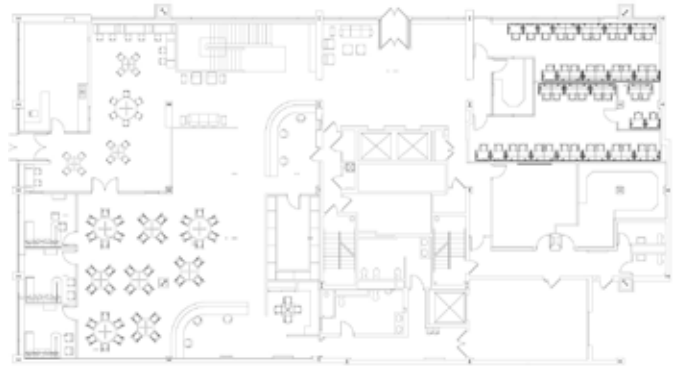

Result:

- **product selection:** flexible, mobile seating; refurbished product
- **future-focused:** provides a state-of-the-art template for smart, active-learning spaces
- **college brand:** casual, open layout takes advantage of street-level windows as a marketing tool
- **campus atmosphere:** the ability to offer the same student services as on the main campus

