

JEFFERSON VALLEY MALL



LOTH

Steelcase
Authorized Dealer



COLUMBUS
CEO

Project:
Jefferson Valley
Mall

**WASHINGTON
PRIME GROUP®**

jefferson valley mall | considerations

\$71,000 BUDGET

Soft seating to compliment the 9/2019 refresh of the malls soft seating.

Focus on main entrances in 8 locations

Create a dynamic first impression when entering the mall from focused entrances



jefferson valley mall | upper level | setting locations

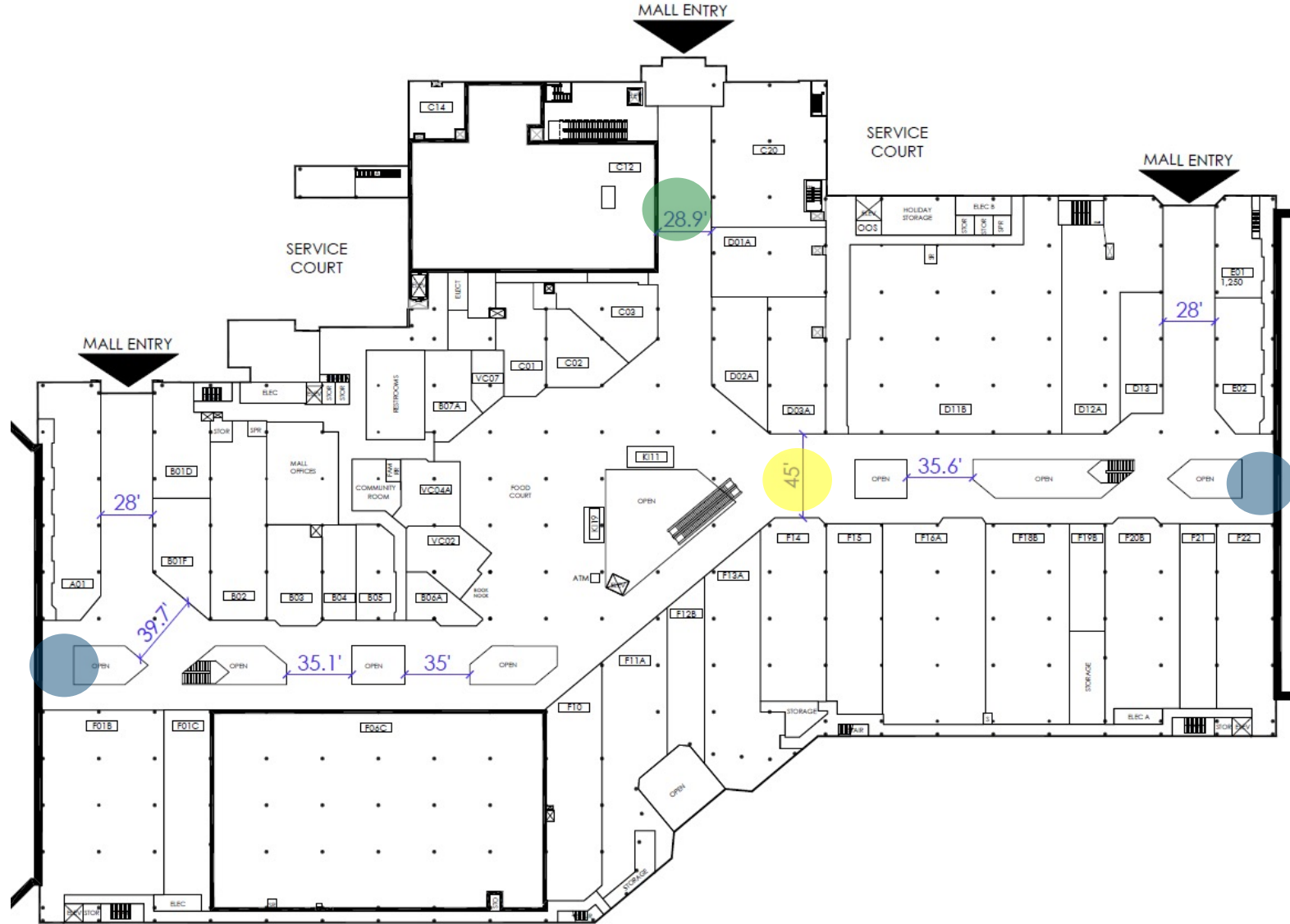

jefferson valley mall | lower level | setting locations

- setting 1
- setting 2
- setting 3



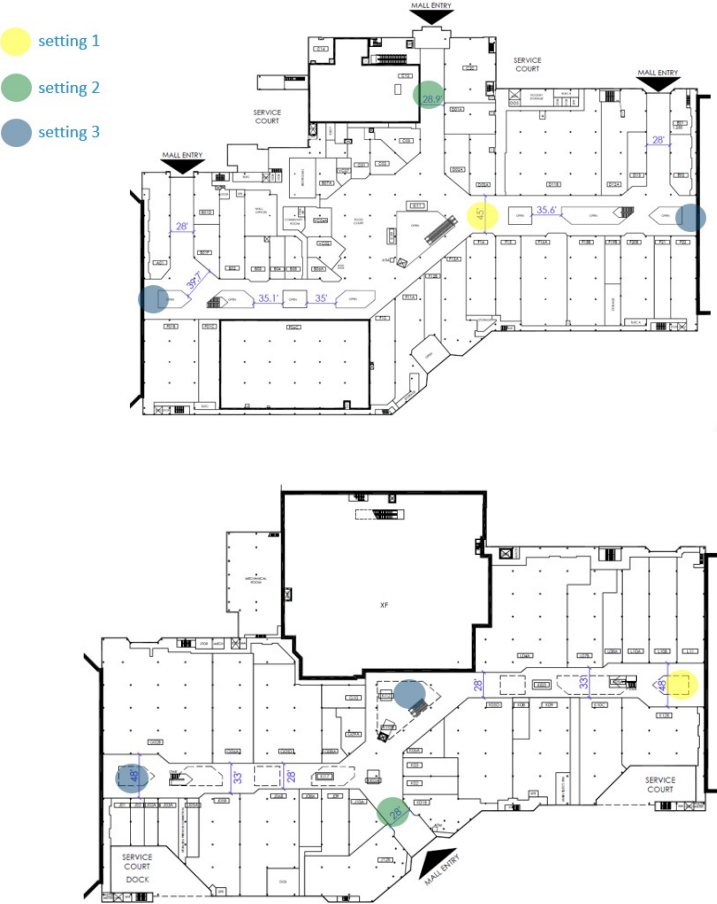
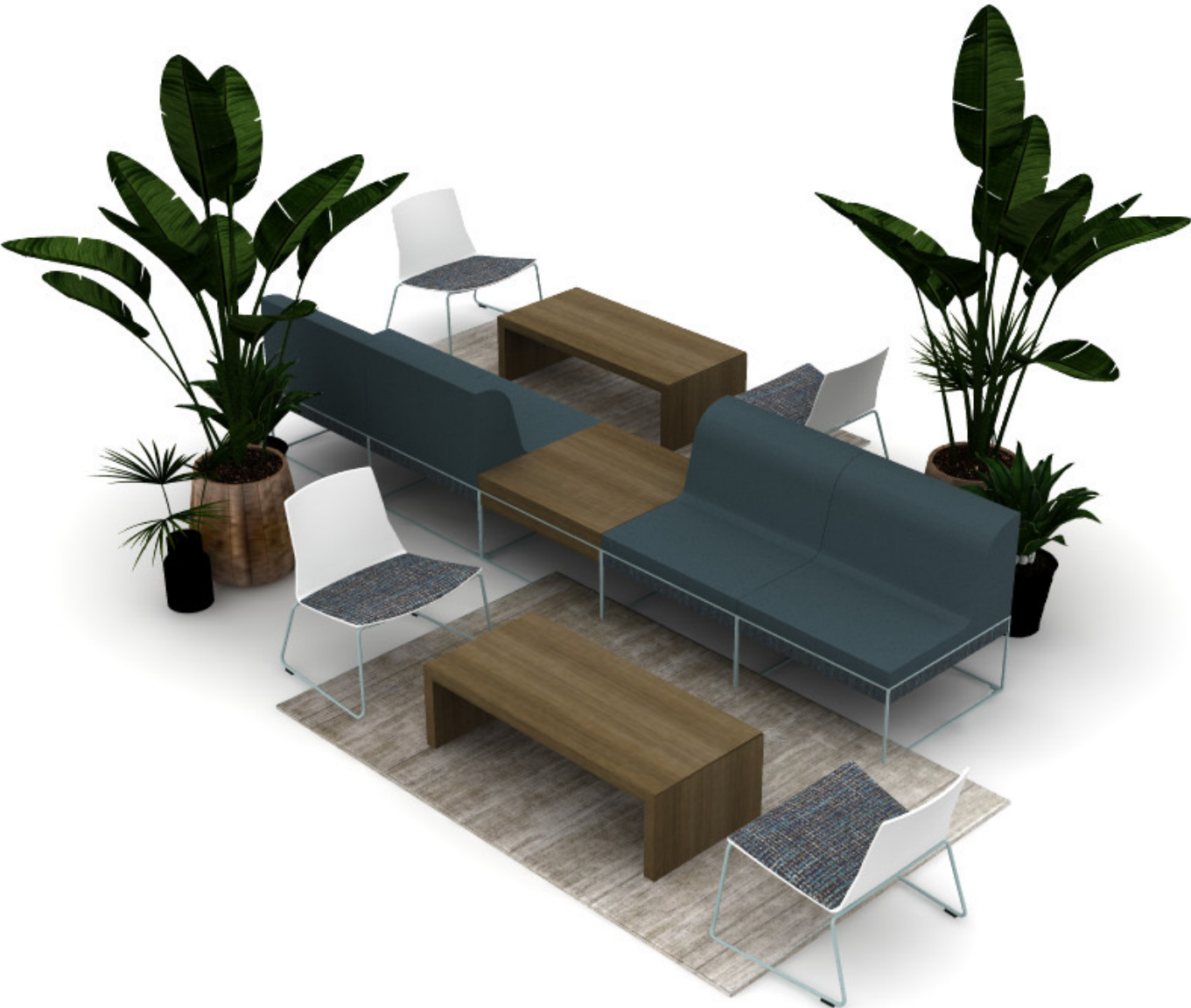



upholstered seat only

sectional fabric
brisa cambridge



sectional accent fabric
bark cloth navy

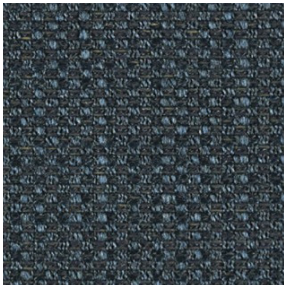
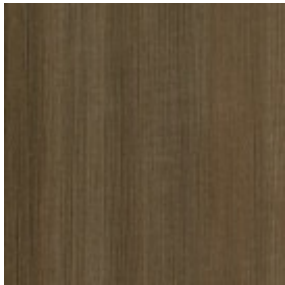

table laminate
graphite walnut



base/legs
sea salt



Custom A Carpenter's Son
waterfall coffee table
(approx. 48"x22"x15"H)
stain will match as closely
as possible to umami tables

ACS coffee table to
match as closely as
possible

seat cushion
sherlock blueberry



wood frame
white oak



base/legs
sea salt





Custom A Carpenter's Son
solar slab coffee table
(approx. 36-48" diameter)
*image in rendering is
placeholder only



- setting 1
- setting 2
- setting 3

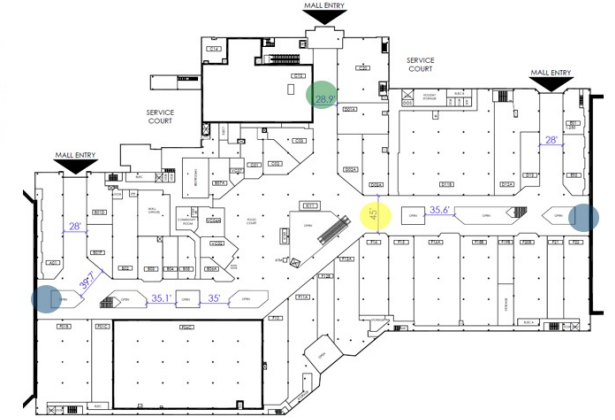



chair shell
white poly

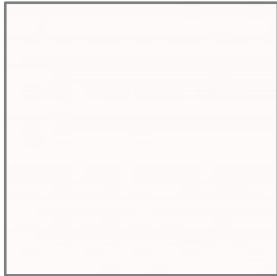

chair cushion
new black harley



stool base
baltic



upholstery fabric
foundation sailor



accent fabric
billiard sea salt



base paint
baltic



table laminate
graphite walnut

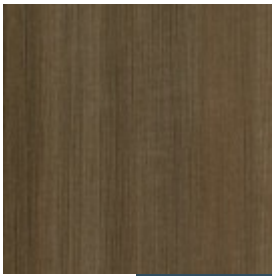

table base
baltic



a carpenter's son
solar slab coffee table
(approx. 36-48" diameter)
stain will match as
closely as possible to
café tables, base to be
Powdercoated white



- *this setting includes 2 benches with steel U legs, white powdercoat
- *60"L x 24"W x 18"H
- *suggesting you place a set of planters between the benches
- *finish similar to other wood tones in this plan



jefferson valley mall | palette | links attached to each for further information

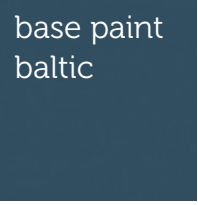
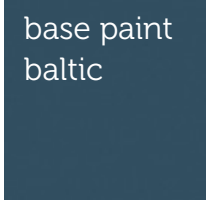
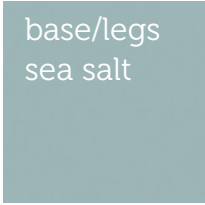
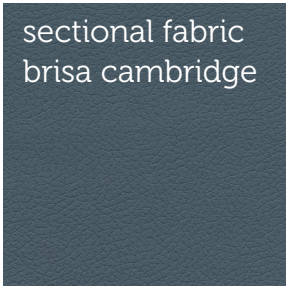

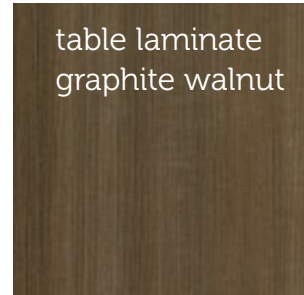
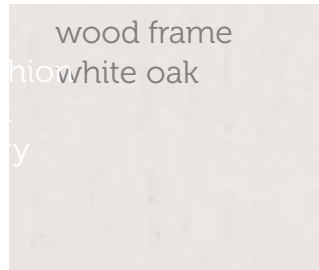

table laminate
graphite walnut



wood frame
white oak



chair shell
white poly

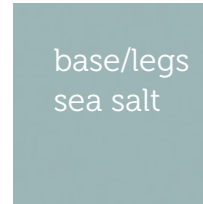

base/legs
sea salt



base
paint
baltic



chair cushion
new black
harley

1. Use one of the 5 cleaners listed below.
2. Spray hard surfaces lightly and evenly.
3. Wipe dry.
 - Lysol Disinfecting Wipes
 - Formula 409 Disinfecting Spray
 - Clorox Non-Bleach Disinfecting Wipes
 - Lysol All Purpose Spray Cleaner
 - Fantastik All Purpose Spray Cleaner
 - [Link](#)

- 1. Mix** 1-part clear dish detergent and 16 parts water in a spray bottle.
 - 2. Spray soft surface** lightly and evenly until damp. The spray should coat the surface but not soak through.
 - 3. Let sit** for 1-2 minutes.
 - 4. Use a wet/dry vacuum** (such as a Shop Vac) to remove all moisture from the surface.
 - 5. Allow to air dry** until completely dry.
- [Link](#)

sectional fabric
brisa cambridge

100% Polyurethane Surface 65% Polyester, 35% Rayon backing
Wipe up spills as soon as they occur • Clean with soap and water • Sanitize using disinfectants such as (1:5) bleach/water solution • For stubborn stains, wipe off with isopropyl alcohol as soon as possible* • Thoroughly rinse all solution residue with clean water • Air dry.
[Link](#)

table laminate
graphite walnut

40% Acrylic, 60% Polyester (Preconsumer Recycled)
Water-based/Solvent (W/S)
[Link](#)

Seat cushion
sherlock blueberry

73% Polyester, 27% Viscose
Peroxy Hdox Green Dilution Light Duty
[Link](#)

faux leather
stand in orca

100% Polyurethane
Bleach Cleanable
Bleach – 1:10 Diluted
[Link](#)

accent fabric
billiard sea salt

100% Polyester
Mix 1-part clear dish detergent and 16 parts water in a spray bottle. Spray soft surface lightly and evenly until damp. The spray should coat the surface but not soak through. Let sit for 1-2 minutes. Use a wet/dry vacuum (such as a Shop Vac) to remove all moisture from the surface. Allow to air dry until completely dry.
[Link](#)

thank you

LOTH

Grandview Work Studio
855 Grandview Ave.
Columbus, OH 43215
www.lothinc.com

Julie Voss

Leader, Emerging Workplaces
c. 614.582.2997
e. jvoss@lothinc.com

Lorene Haimerl

Executive Vice President, Sales
c. 614.425.8805
o. 614.487.4143
e. lhaimerl@lothinc.com

Amber Blair

Workplace Advisor
c. 419.236.9879
e. ablair@lothinc.com