

JEFFERSON VALLEY MALL



LOTH

Steelcase
Authorized Dealer



COLUMBUS
CEO

Project:
Jefferson Valley
Mall

**WASHINGTON
PRIME GROUP®**

jefferson valley mall | considerations

\$71,000 BUDGET

Soft seating to compliment the 9/2019 refresh of the malls soft seating.

Focus on main entrances in 8 locations

Create a dynamic first impression when entering the mall from focused entrances



jefferson valley mall | upper level | setting locations

- setting 1
- setting 2
- setting 3

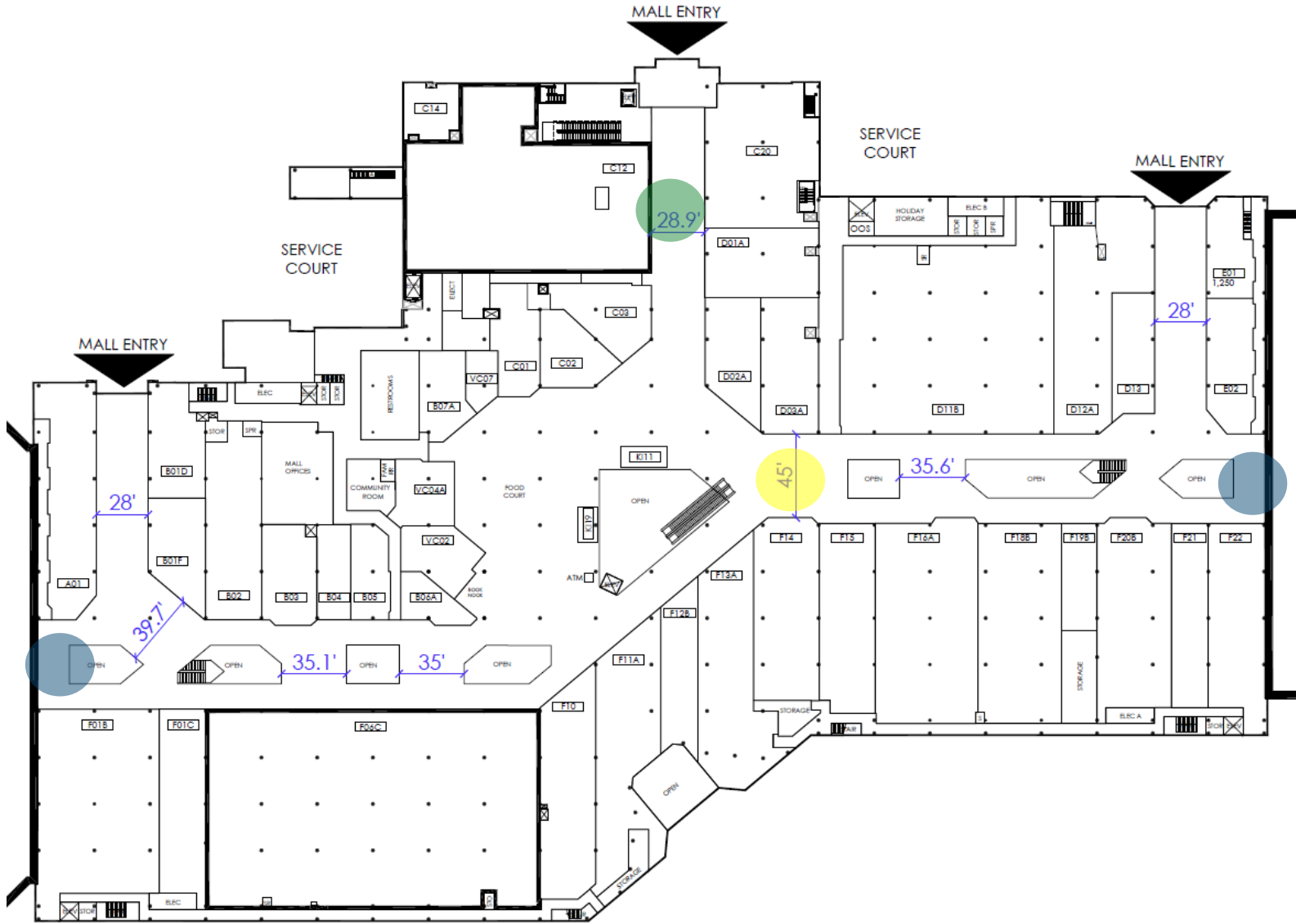

jefferson valley mall | lower level | setting locations



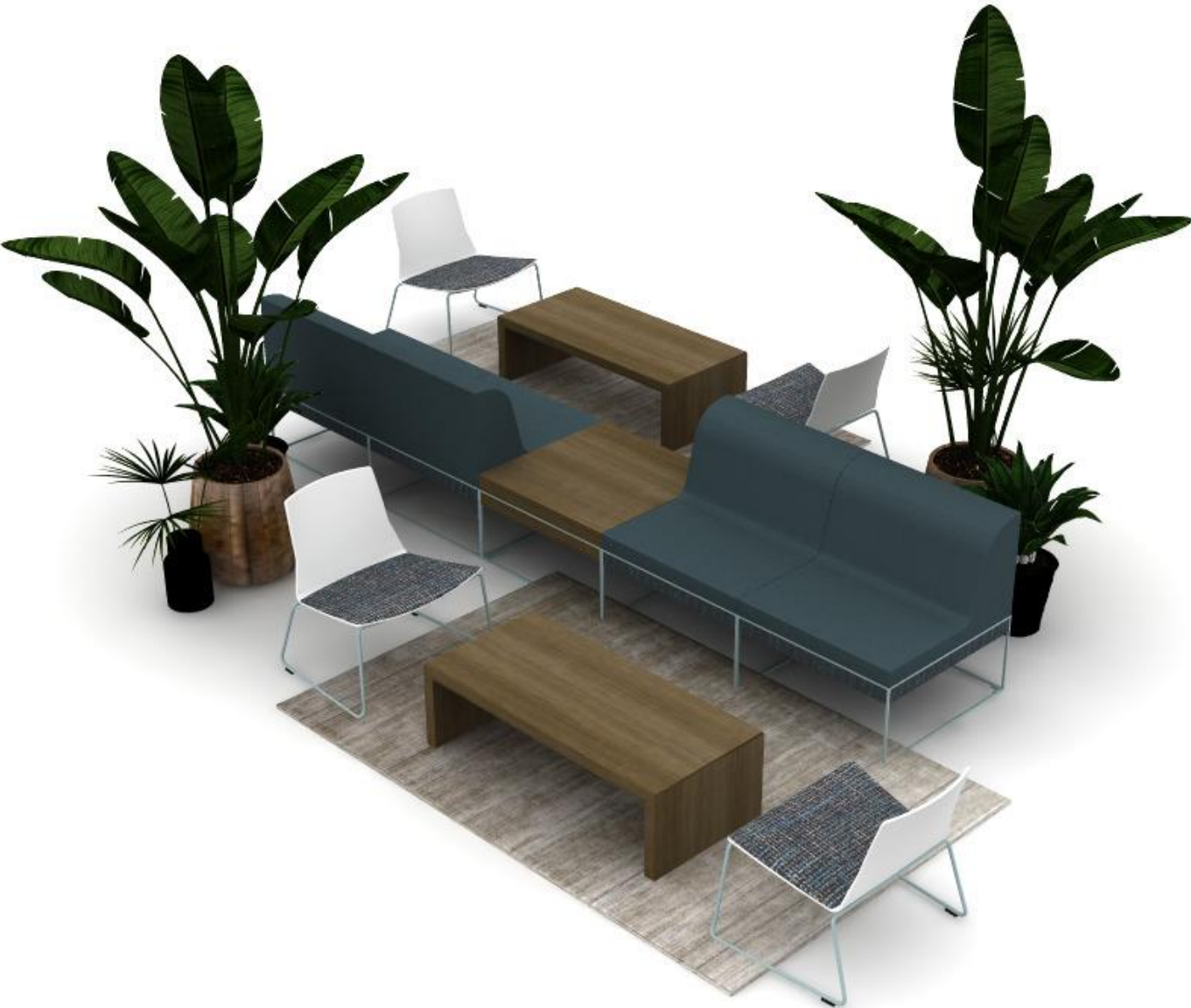

- setting 1
- setting 2
- setting 3

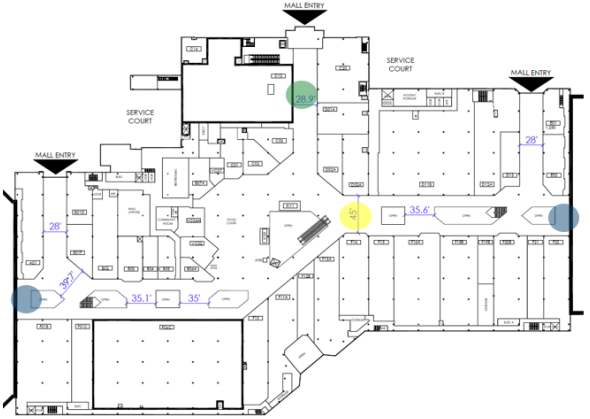



upholstered seat only

sectional fabric
brisa cambridge



sectional accent fabric
bark cloth navy



table laminate
graphite walnut



base/legs
sea salt

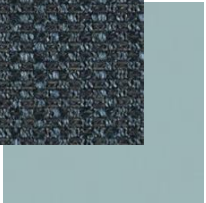

ACS coffee table to
match as closely as
possible

seat cushion
sherlock blueberry



wood frame
white oak



base/legs
sea salt



Custom A Carpenter's Son
waterfall coffee table
(approx. 48"x22"x15"H)
stain will match as closely
as possible to umami tables



Custom A Carpenter’s Son
solar slab coffee table
(approx. 36-48” diameter)
*image in rendering is
placeholder only



- setting 1
- setting 2
- setting 3

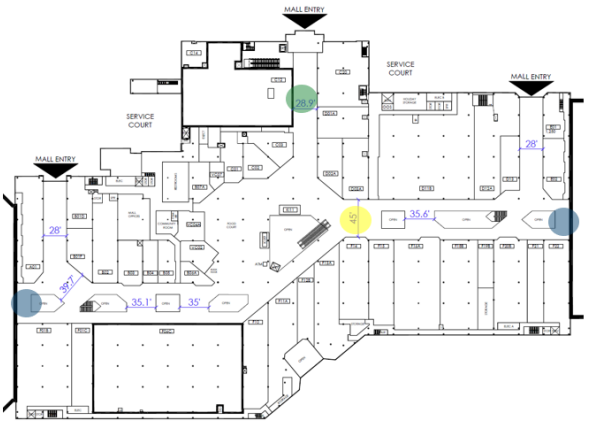



chair shell
white poly

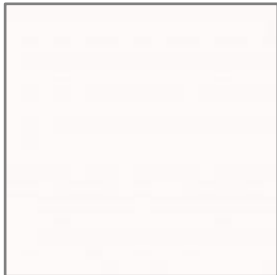

chair cushion
new black harley



stool base
baltic



table laminate
graphite walnut



table base
baltic



upholstery fabric
foundation sailor



accent fabric
billiard sea salt



base paint
baltic



a carpenter's son
solar slab coffee table
(approx. 36-48" diameter)
stain will match as
closely as possible to
café tables, base to be
Powdercoated white



- *this setting includes 2 benches with steel U legs, white powdercoat
- *60"L x 24"W x 18"H
- *suggesting you place a set of planters between the benches
- *finish similar to other wood tones in this plan



jefferson valley mall | palette | links attached to each for further information

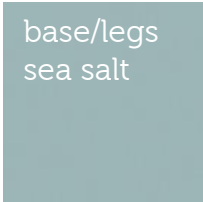
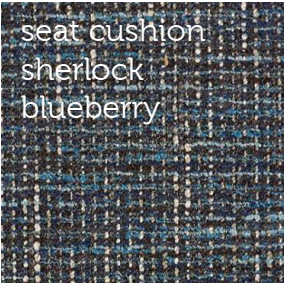
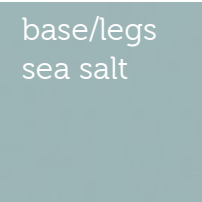
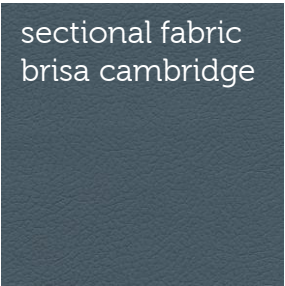

thank you

LOTH

Grandview Work Studio
855 Grandview Ave.
Columbus, OH 43215
www.lothinc.com

Julie Voss

Leader, Emerging Workplaces
c. 614.582.2997
e. jvoss@lothinc.com

Lorene Haimerl

Executive Vice President, Sales
c. 614.425.8805
o. 614.487.4143
e. lhaimerl@lothinc.com

Amber Blair

Workplace Advisor
c. 419.236.9879
e. ablair@lothinc.com